

# Grapa 530 *Staple 530*

Grapas manuales *Intended for use with manual staplers*



## Acabado *Finish*

 Galvanizado  
*Galvanized*

## Grapas por peine *Strip Length*

100

## Galga *Gauge*

 Escanea el código  
QR para más info

*Scan the QR code  
for more info*

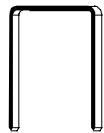

## Largo pata *Leg length*

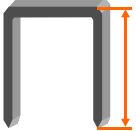
	min	4	5/32"
	mm		inch
	máx	16	5/8"
	mm		inch

## Puente interior *Inside crown*

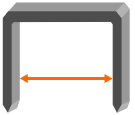
	10,1	0,397
	± 0,3 mm	± 0,011 inch

## Ancho pata *Leg width*

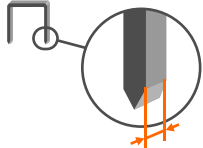
	0,75	0,029
	mm	inch

## Punta *Point*

	Cinzel <i>Chisel</i>
---	-------------------------

## Puente exterior *Outside crown*

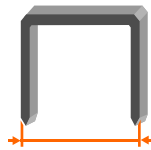
	11,20	0,440
	± 0,3 mm	± 0,011 inch

## Espesor pata *Leg thickness*

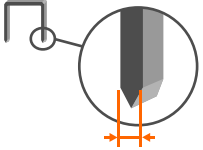
	0,55	0,021
	mm	inch